

1200-0004\_03

Models: 1207-0008  
1207-0010

### 1207D Disc/Cone Clutch

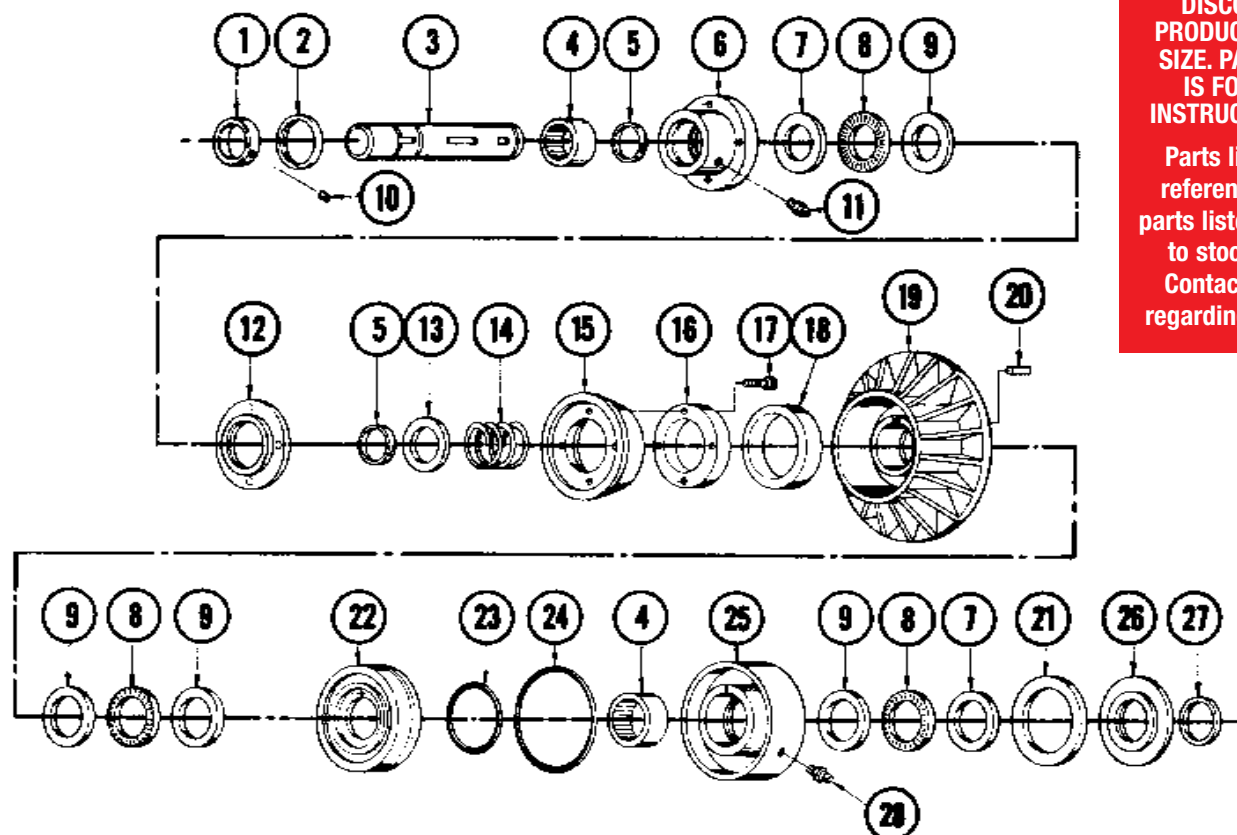

(02/01/2026)  
DISCONTINUED  
PRODUCT STYLE OR  
SIZE. PARTS SHEET  
IS FOR REPAIR  
INSTRUCTIONS ONLY.

Parts listing is for  
reference only. All  
parts listed are limited  
to stock on hand.  
Contact Tolomatic  
regarding availability.

ITEM	PART NO.	DESCRIPTION	1207-0008	1207-0010
1.	1307-1008	SHAFT COLLAR		1
2.	1207-1016	RETAINING RING	1	1
3.	1207-1018	SHAFT, 1/2" BORE	1	
	1207-1019	SHAFT, 5/8" BORE		1
4.	1307-1015	ROLLER BEARING	2	2
5.	1307-1013	RETAINING RING	2	2
6.	1207-1012	ADAPTER	1	1
7.	1307-1009	BEARING RACE	2	2
8.	0200-1214	THRUST BEARING	3	3
9.	1307-2009	BEARING RACE	4	4
10.	1301-1174	SET SCREW	2	2
11.	1208-1034	GREASE FITTING	1	1
12.	1207-1002	CONE ADAPTER	1	1
13.	1207-1008	WASHER	1	1
14.	1207-1033	SPRING	1	1

ITEM	PART NO.	DESCRIPTION	1207-0008	1207-0010
15.	1207-1003	CONE	1	1
16.	1207-1009	ADAPTER RING	1	1
17.	1307-2018	SOC. HEAD CAP SCREW	4	4
18.	1207-1011	FELT SCREW	2	2
19.	1207-1004	CUP	1	1
20.	1300-1012	KEY	1	1
21.	1207-1010	FELT SEAL	1	1
22.	1207-1005	PISTON	1	1
23.	0720-1004	O-RING SEAL	1	1
24.	1207-1014	O-RING SEAL	1	1
25.	1207-1006	CYLINDER	1	1
26.	1207-1007	SEAL ADAPTER	1	1
27.	1207-1060	RETAINING RING	1	1
28.	0100-1601	GREASE FITTING	1	1

## INSTALLATION

The Tolomatic Disc/Cone Clutch is as simple to install as a sprocket or sheave. Simply slip the clutch over the shaft to the desired position, align with keyway and insert key. After final alignment with mating sprocket or sheave, tighten set screws to lock clutch in place.

Connect air or hydraulic source (not over 100 psi pressure) to cylinder port. Make sure no side or end thrust is transmitted to clutch. Flexible hose (**not plastic tubing**) may be used. A restraining member may be necessary to prevent cylinder rotation.

**(02/01/2026) DISCONTINUED PRODUCT  
STYLE OR SIZE. PARTS SHEET IS FOR  
REPAIR INSTRUCTIONS ONLY.**

**Parts listing is for reference only. All  
parts listed are limited to stock on hand.  
Contact Tolomatic regarding availability.**

## MAINTENANCE

Lubrication will be required after every 4 weeks of operation. Use a lubricant such as ORE-LUBE G-1/3. \* Two zerk fittings are provided for this purpose.

After long periods of operation, it may be necessary to disassemble the clutch for cleaning and inspection.

**CAUTION: CLUTCHES ARE UNDER SPRING TENSION. USE CARE  
WHEN DISASSEMBLING.**

To disassemble, remove the retaining rings from the cylinder end of the clutch shaft and slide all parts off this end. Assemble all parts onto the shaft from the opposite end. This procedure is necessary to keep from damaging the edges of the bearing seal lips. See exploded view on the other side for proper sequence of assembly.

Wipe off all old lubricant before applying fresh grease. Use Ore-Lube\* G-1/3 or similar. If it is necessary to remove the piston from the cylinder, re-lubricate the O-rings with a mineral base O-ring grease.

Remove any grease that may have contacted the cone and clean out any foreign material in the cup. Be careful not to re-contaminate any internal parts.

If these simple procedures are followed, your Tolomatic Disc/Cone Clutch will give you years of trouble-free service.

ORE-Lube is a trademark of ORE-Lube Corp., <https://www.orelube.com>

**Tolomatic**<sup>TM</sup>  
EXCELLENCE IN MOTION

3800 County Road 116, Hamel, MN 55340 USA  
<http://www.Tolomatic.com> • Email: [Help@Tolomatic.com](mailto:Help@Tolomatic.com)  
Phone: (763) 478-8000 • Toll Free: 1-800-328-2174

© 2026 Tolomatic 202601120937

COMPANY WITH  
QUALITY SYSTEM  
CERTIFIED BY DNV  
= ISO 9001 =

All brand and product names are trademarks or registered trademarks of their respective owners. Information in this document is believed accurate at time of printing. However, Tolomatic assumes no responsibility for its use or for any errors that may appear in this document. Tolomatic reserves the right to change the design or operation of the equipment described herein and any associated motion products without notice. Information in this document is subject to change without notice.

Visit [www.tolomatic.com](http://www.tolomatic.com) for the most up-to-date technical information